

CROSS, PN16

712/1510-001

Flange, blue RAL5017 EP coating to GSK

Water Supply

Wastewater Treatment

Water Treatment

Dams, Reservoirs and Hydropower

Irrigation

AVK's range of fittings comprises a wide selection of variants with socket and flange connection. The fittings are made of ductile iron GJS-500-7 and are epoxy coated according to DIN 3476 and GSK specifications - internally and externally.

Use:

Cross in ductile iron for water and other neutral liquids to max. 70°C

Standards:

- EN 545
- Flange drilling to EN1092, PN10/16

Test/Approvals:

- Belgaqua approved material

Features:

- Ductile iron fitting to EN 545
- Body of GJS-500-7
- Epoxy coated to DIN 3476 and GSK internally and externally



The designs, materials, dimensions and specifications shown are subject to change without notice due to the continuous development of our product range.

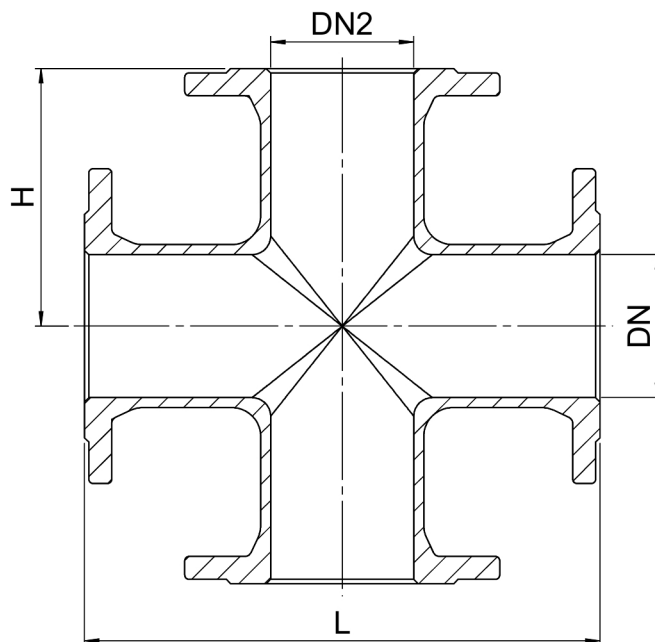

Component list:

1. Fitting	Ductile Iron
------------	--------------

Components may be substituted with equivalent or higher class materials without prior notification.

Reference nos. and dimensions:

Reference no.	DN mm	DN2 mm	Flange drilling	L mm	H mm	Theoretical weight/kg
712-0080-15-101	80	80	PN10/16	330	165	19
712-0100-15-101	100	100	PN10/16	360	180	23
712-0101-15-101	100	80	PN10/16	360	175	22
712-0125-15-101	125	125	PN10/16	400	200	29
712-0150-15-101	150	150	PN10/16	440	220	37
712-0152-15-101	150	100	PN10/16	440	210	31
712-0200-15-100	200	200	PN10	520	260	55
712-0200-15-101	200	200	PN16	520	260	56
712-0201-15-100	200	150	PN10	520	250	56
712-0201-15-101	200	150	PN16	520	250	56
712-0203-15-100	200	100	PN10	520	240	43
712-0203-15-101	200	100	PN16	520	240	51
712-0250-15-100	250	250	PN10	700	350	89
712-0250-15-101	250	250	PN16	700	350	87
712-0251-15-100	250	200	PN10	700	325	74
712-0251-15-101	250	200	PN16	700	325	80
712-0252-15-100	250	150	PN10	700	300	66
712-0252-15-101	250	150	PN16	700	300	66
712-0254-15-100	250	100	PN10	700	275	58
712-0254-15-101	250	100	PN16	700	275	58
712-0300-15-100	300	300	PN10	800	400	122
712-0300-15-101	300	300	PN16	800	400	122
712-0301-15-100	300	250	PN10	800	375	103
712-0301-15-101	300	250	PN16	800	375	103
712-0302-15-100	300	200	PN10	800	350	118
712-0302-15-101	300	200	PN16	800	350	118
712-0303-15-100	300	150	PN10	800	325	86
712-0303-15-101	300	150	PN16	800	325	86
712-0305-15-100	300	100	PN10	800	300	79
712-0305-15-101	300	100	PN16	800	300	79

The designs, materials, dimensions and specifications shown are subject to change without notice due to the continuous development of our product range.

Reference nos. and dimensions:

Reference no.	DN mm	DN2 mm	Flange drilling	L mm	H mm	Theoretical weight/kg
712-0400-15-100	400	400	PN10	900	450	185
712-0400-15-101	400	400	PN16	900	450	262
712-0401-15-101			PN16			-
712-0402-15-100	200					269
712-0402-15-101	400		PN16			269
712-0405-15-100	200		PN10			237
712-0500-15-100	500	500	PN10	1000	500	261
712-0500-15-101	500	500	PN16	1000	500	320
712-0600-15-100	600	600	PN10	1100	550	362
712-0600-15-101	600	600	PN16	1100	550	464