

FLANGED PIPE

712/6110-001

PIPE W/WALL SLEEVE, PN 10/16

Water Supply

Wastewater Treatment

Water Treatment

Dams, Reservoirs and Hydropower

Irrigation

AVK's range of fittings comprises a wide selection of variants with socket and flange connection. The fittings are made of ductile iron GJS-500-7 and are epoxy coated according to DIN 3476 and GSK specifications - internally and externally.

Use:

Flanged pipe with wall sleeve type FF-WP for water, waste water and neutral liquids to max. 70° C

Standards:

- EN 545
- Flange drilling to EN1092, PN10/16

Features:

- Ductile iron fitting to EN 545
- Body of GJS-500-7
- Epoxy coated to DIN 3476 and GSK internally and externally

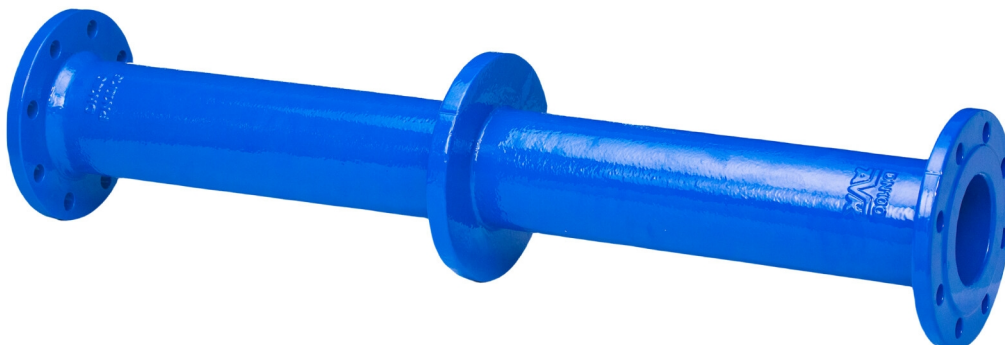

The designs, materials, dimensions and specifications shown are subject to change without notice due to the continuous development of our product range.

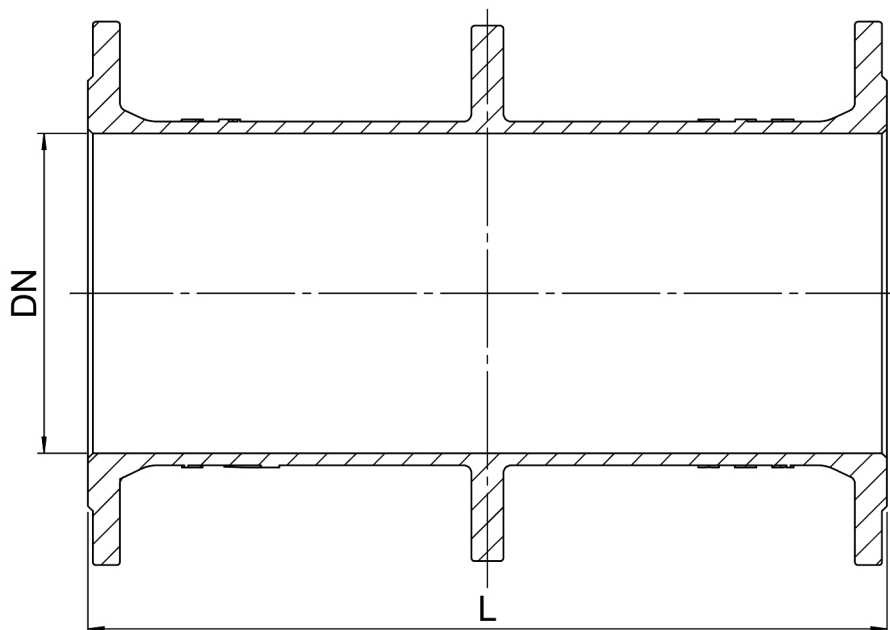

Component list:

1. Fitting	Ductile Iron
------------	--------------

Components may be substituted with equivalent or higher class materials without prior notification.

Reference nos. and dimensions:

Reference no.	DN mm	Flange drilling	L mm	Theoretical weight/kg
712-0100-61-101	100	PN10/16	1000	31
712-0150-61-101	150	PN10/16	1000	40
712-0200-61-100	200	PN10	1000	56
712-0200-61-101	200	PN16	1000	56
712-0250-61-100	250	PN10	1000	76
712-0250-61-101	250	PN16	1000	76
712-0300-61-100	300	PN10	1000	99
712-0300-61-101	300	PN16	1000	99
712-0350-61-100	350	PN10	1000	122
712-0350-61-101	350	PN16	1000	131
712-0400-61-100	400	PN10	1000	148
712-0400-61-101	400	PN16	1000	161
712-0450-61-100	450	PN10	1000	172
712-0450-61-101	450	PN16	1000	203
712-0500-61-100	500	PN10	1000	203
712-0500-61-101	500	PN16	1000	244
712-0600-61-100	600	PN10	1000	265
712-0600-61-101	600	PN16	1000	344